

9 Install Intel® Remote Management Modules (optional)

Install Intel® RMM NIC Module

Install Foam Gasket

- A** A self-adhesive foam gasket is required to protect the underside of the NIC module.

Remove the backing paper from the spacer and install as shown.

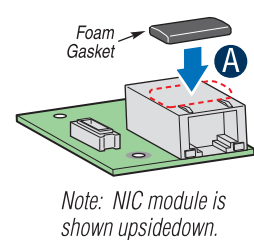

Note: NIC module is shown upsidedown.

- B** Install the three standoffs to the server board first.

- C** Attach module to the server board connector and matching standoffs.

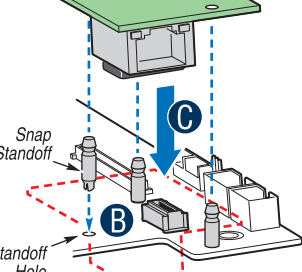

Install Intel® RMM Module

- A** Insert the standoff into the hole labeled TH4 on the Intel® Remote Management Module. The standoff installs on the bottom side of the Intel® Remote Management Module.

- B** Attach the Intel® Remote Management Module to the server board connector and snap the standoff into the matching hole in the server board.

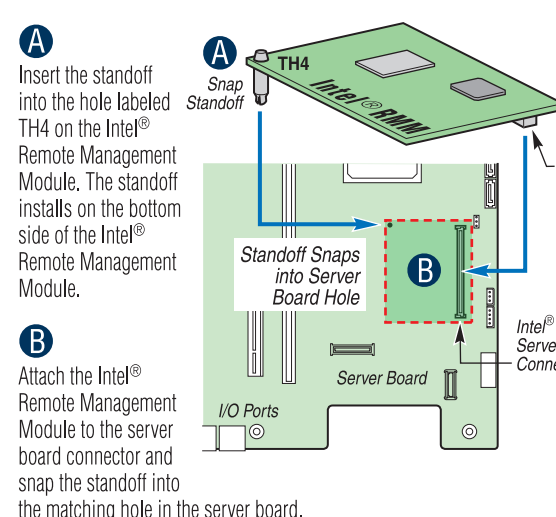

10 Install Optical Device (optional)

1. Remove the Empty Tray

- A** Remove the empty tray and screw from the accessory kit box.

- For installing the optional USB floppy drive in place of a CD-ROM, see #5 below right.

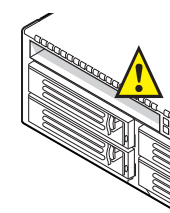

CAUTION: To maintain proper system cooling, a filler blank must be installed if you do not install a device at this location.

2. Install the Interposer Board

- A** Plug the interposer board connector into the matching connector on the back of the optical device.

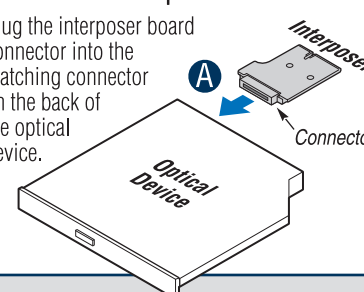

4. Secure Interposer Board to Device Tray

- A** Make sure interposer board fits onto alignment pin on device tray.

- B** Attach with screw as shown.

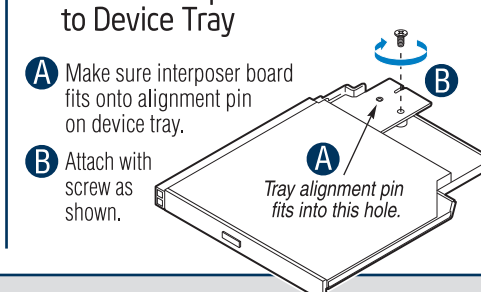

3. Install Device into the Tray

- A** Align the two holes on the left edge of the optical device with the two metal tabs in the tray.

- B** Lower opposite side of optical device into tray until it clicks into place.

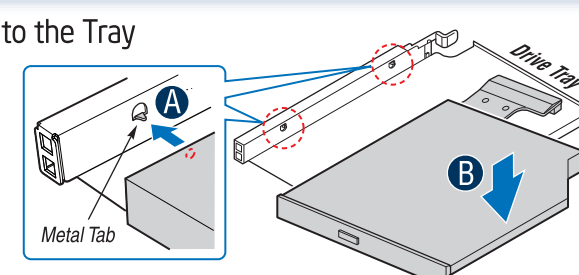

5. Install Optical Device Tray Assembly into the Chassis

- For installing the optional USB floppy drive, note the location of the backplane USB connector at right and refer to the documentation that came with the device.

- A** Insert optical device tray assembly into the chassis.

- B** Verify that the blue release lever on the tray locks into place.

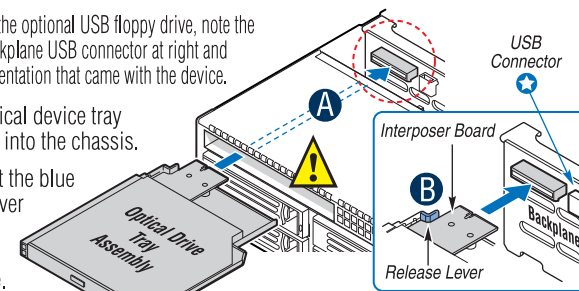

11 Install Add-in Card(s) - Full-height Side of PCI Riser Shown

- A** Open rear retention clip by pushing blue slide upward and rotating clip fully open.
- B** Open front retention clip by rotating 90 degrees outward.
- C** Remove filler panel from the selected add-in card slot.
- D** Insert add-in card until it seats in riser connector.
- E** Close both retention clips. Note: Make sure that all empty add-in card slots have filler panels installed.

CAUTION: Observe normal ESD precautions when installing add-in cards.

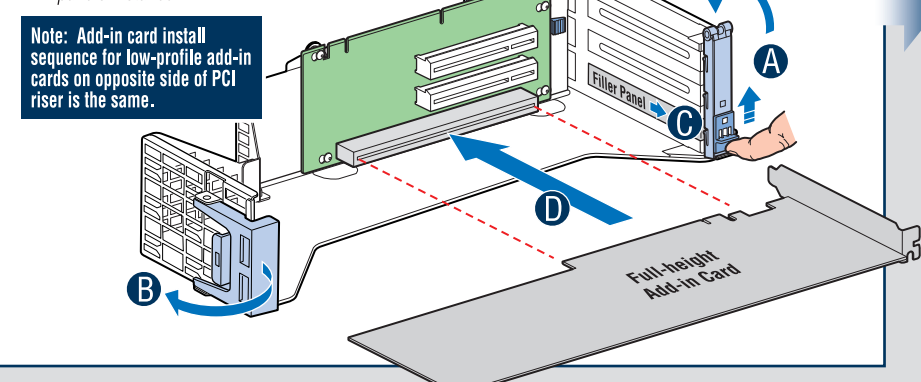

12 Install PCI Add-in Card Riser Assembly

To install the riser assembly:

- A** Position riser card edge connector(s) over the server board riser socket(s) and align the three hooks in the riser with the slots at the back of the chassis.

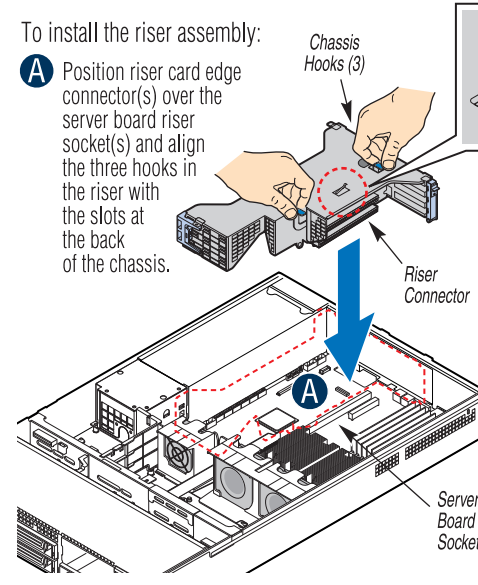

Note: The PCI riser assembly includes an intrusion switch that engages the system cover. Do not use the intrusion header located on the server board.

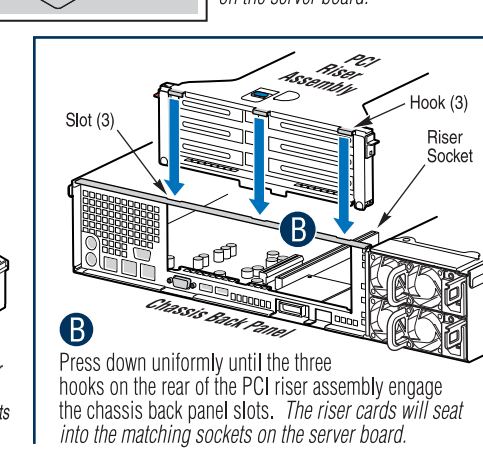

13 Second Processor Duct Modification

Configure Processor Air Duct for Two Processors:
Note: This step only applies if your system has two processors. If only one processor is installed, leave the air dam in place and proceed to Step 15.

CAUTION: The CPU air dam must be in place for single processor configurations to ensure proper system cooling. Retain the air dam for future use.

- A** Turn processor air duct over to reveal underside.

- B** Remove CPU air dam by sliding slotted holes off of duct pins.

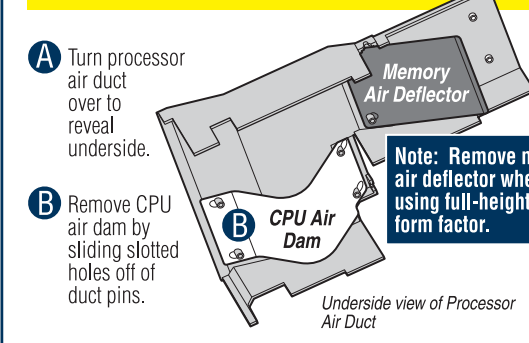

14 Install Processor Air Duct

Install processor air duct as shown.

Use care to avoid pinching system cables.

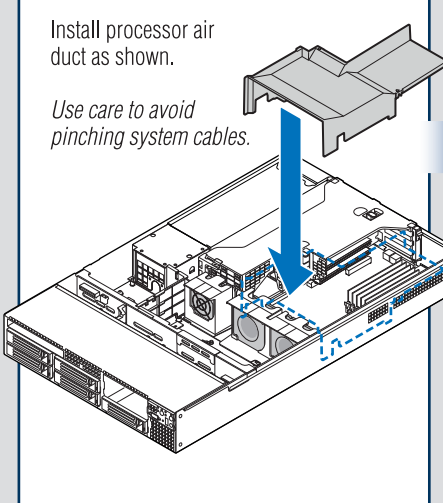

15 Install Hard Drives/Carriers

- A** Remove the Plastic Air Baffle

- B** Install the Hard Disk Drive

- C** Install the Carrier Assembly

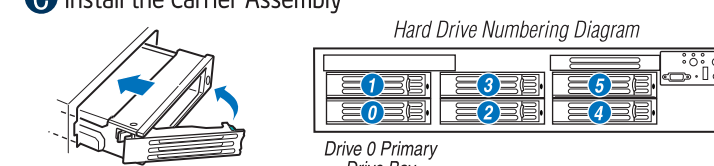

Note: Carrier lever must be held in the FULLY OPEN position to install into chassis. Slide carrier into chassis until it stops, then rotate the lever until it snaps shut.

CAUTIONS: If you install less than six drives or devices, empty drive bays must be occupied by carriers with baffles to maintain proper system cooling. To avoid possible damage to your chassis, use only carriers that came with your server system.

16 Install 6th Hard Drive or Tape Drive (optional)

See the chassis user's guide for optional sixth hard disk drive or tape drive installation instructions.

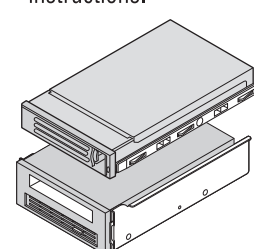

17 Install Second Power Supply Module (optional)

- A** Use the "finger hole" to remove the filler panel.

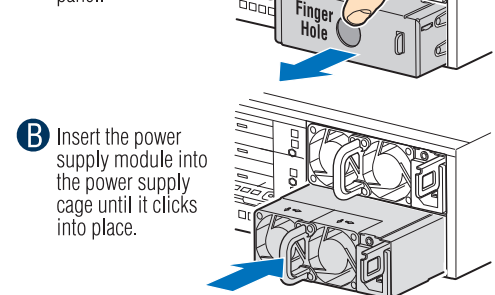

- B** Insert the power supply module into the power supply cage until it clicks into place.

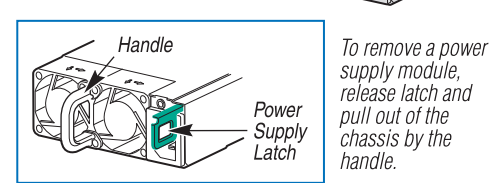

To remove a power supply module, release latch and pull out of the chassis by the handle.

18 Install Intel® Local Control Panel (optional)

Remove Standard Control Panel Module

- A** Press the blue locking lever to release the control panel from the chassis.

- B** Slide the standard control panel out of the chassis.

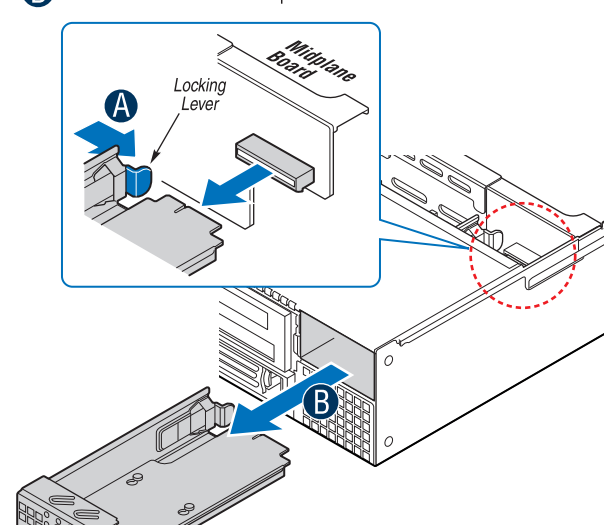

- A** Slide Intel® Local Control Panel into chassis.

- B** Make sure control panel engages the backplane connector and the blue locking lever snaps into place.

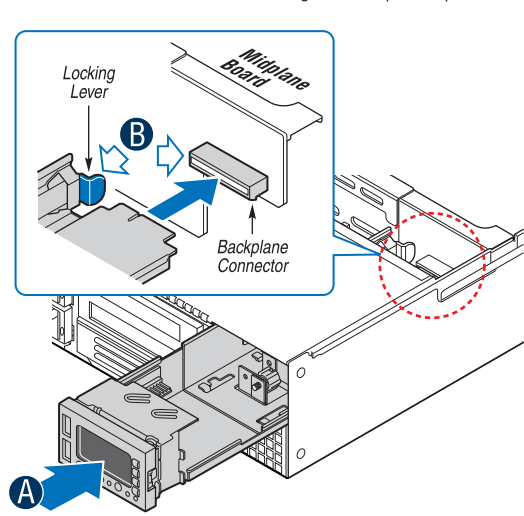

19 Install Rack Handles

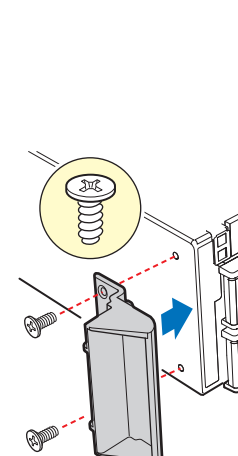

20 Install Bezel (optional)

Standard Control Panel Bezel

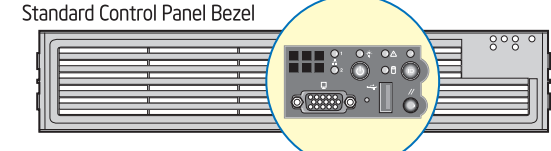

Intel® Local Control Panel Bezel

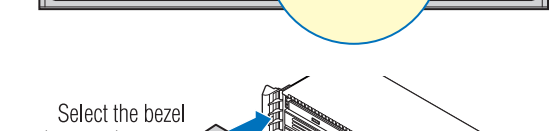

Select the bezel that matches your control panel and install as shown.

21 Install Top Cover

Note: Security screw re-installation is optional.

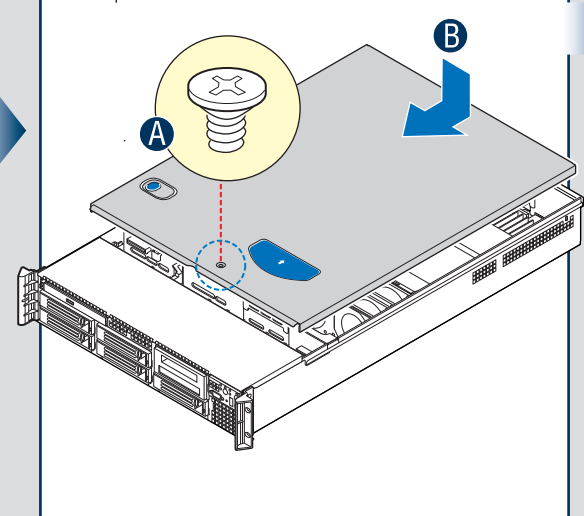

22 Finishing Up

Before installing your operating system, you must finish your system installation and connect back panel I/O connectors and AC power.

- Replace the system cover.
- Connect your keyboard, mouse, video and other I/O cables/devices as shown. Then connect the AC power cord(s).

IMPORTANT NOTE: You must download and install the latest Intel® RMM software for the Intel® RMM boards to work properly with your server board.

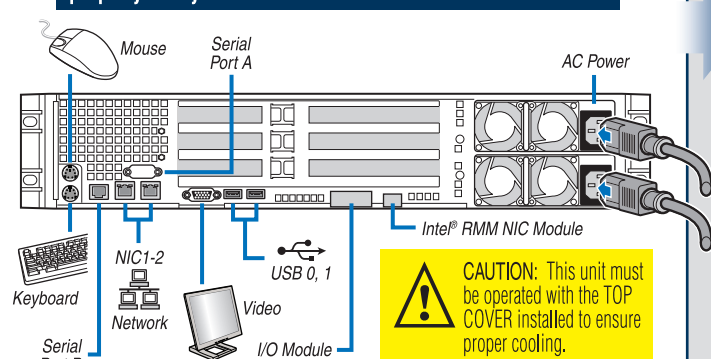

CAUTION: This unit must be operated with the TOP COVER installed to ensure proper cooling.

23 Software - BIOS, Drivers, and Operating System Installation

A. Update the System Software:

1. Boot from the Intel® Server Deployment Toolkit 2.0 CD.
2. Use the Wizard to access the latest versions on the Internet and update the BIOS, firmware, and FRUSDRs. (Downloaded files on a USB key may also be used).

B. Configure your RAID Controller: If using a RAID card, use the instructions provided with the RAID controller. If using on-board RAID, you must activate RAID in the BIOS setup. See the Intel® 5000 Series Chipsets Server Board Family Datasheet for more information.

C. Install your Operating System: Use the instructions provided with the RAID controller and with the operating system.

D. Install Operating System Drivers: With the operating system running, insert the Intel® Server Deployment Toolkit 2.0 CD. If using a Microsoft® Windows® operating system, the Express Installer will autoun and allow you to select the appropriate drivers to install. On other operating systems, browse the CD folders to locate and install the driver files.

E. Install Intel® Remote Management Software: If you installed the Intel® Remote Management Module and the Intel® RMM NIC, download and install the Intel® Remote Management Software from <http://support.intel.com/support/motherboards/server/chassis/sr2500>.

F. Install Intel® SMART Tool (optional): With the operating system running, insert the Intel® Server Deployment Toolkit 2.0 CD. The Express Installer will autoun. Click Intel® SMART Tool at the left side of the screen. Follow the on-screen instructions. For information about Intel® SMART Tool, see <http://developer.intel.com/design/servers/smarttool/index.htm>.

Reference

Front Panel Controls and Indicators

Intel® Local Control Panel

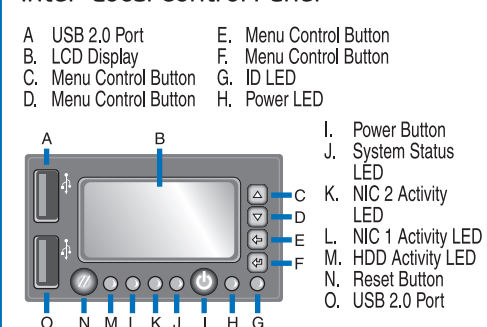

Standard Control Panel

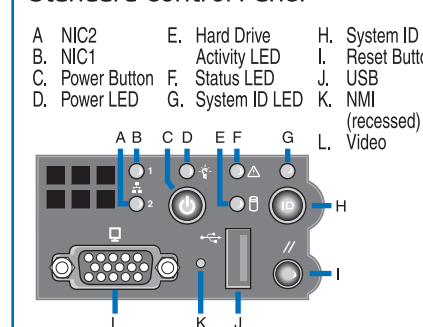

Optional Accessories and Order Codes

Tool-less Rail Kit	AXXHRAIL	Slimline DVD-ROM/CD-ROM Drive	AXXDVCDR
Cable Management Arm	AXXRACKARM	750W Power Supply	ASR2500PS
Basic Slide Rail Kit	AXXBASICRAIL	Sixth SAS/SATA Drive Mounting Kit	ASR2500SIXDRV
Fixed Rack Brackets	AXXBRAKETS	USB Floppy	AXXUSBFLOPPY
Bezel for Standard Control Panel	ADRBZBLACK	SAS/SATA Tape Drive Mounting Kit	ASR2500SATAPE
Bezel for Intel® Local Control Panel	ADRLCDBEZEL	Intel® Local Control Panel	ASR2500LCP
Intel® Remote Management Module	AXXRMM		

A complete list of accessories and spares can be found at: www.intel.com/go/serverbuilder

Intel® Server Board S5000PAL Component Layout

See your Intel® Server Board S5000PAL User's Guide for expanded component and connection information.

