

# intel® Technical Advisory

TA-799-1

5200 NE Elam Young Parkway  
Hillsboro, OR 97124

June 16, 2005

## Intel® Server Chassis SR1450 Drive Bay Interference with the AXXFLOPHDDTRAY (Hard-Drive-to-Floppy Conversion Kit) Accessory

Information in this document is provided in connection with Intel products. No license, express or implied, by estoppel or otherwise, to any intellectual property rights is granted by this document. Except as provided in Intel's Terms and Conditions of Sale for such products, Intel assumes no liability whatsoever, and Intel disclaims any express or implied warranty, relating to sale and/or use of Intel products including liability or warranties relating to fitness for a particular purpose, merchantability, or infringement of any patent, copyright or other intellectual property right. Intel products are not intended for use in medical, life saving, or life sustaining applications. Intel may make changes to specifications and product descriptions at any time, without notice. The **Intel Server Chassis SR1450** may contain design defects or errors known as errata which may cause the product to deviate from published specifications. Current characterized errata are available on request.

### Products Affected

Product Code	MM #
SR1450	869194

### Description

A drive carrier stop pin located in the drive bay of the Server Chassis SR1450 prohibits insertion of the Intel Hard-Drive-to-Floppy Conversion Kit AXXFLOPHDDTRAY. This drive carrier stop pin was installed in the Server Chassis SR1450 to prevent older drive carriers from being installed. These older drive carriers are not compatible with the Server Chassis SR1450.

### Root Cause

The interference is created by a drive carrier stop pin inside the drive bay of the Server Chassis SR1450. The stop pin interferes with the cage of the Hard-Drive-to-Floppy Conversion Kit and prohibits its full insertion into the server chassis.

### Corrective Action/Resolution

Intel will be modifying the AXXFLOPHDDTRAY Hard-Drive-to-Floppy Conversion Kit to correct the interference with the Server Chassis SR1450 hard drive carrier stop pin. The schedule for this modified Hard-Drive-to-Floppy Conversion Kit is to be determined.

### Workarounds

There are two workarounds for this issue: removal of the stop pin and flexing the cage of the conversion kit during installation.



# intel® Technical Advisory

TA-799-1

5200 NE Elam Young Parkway  
Hillsboro, OR 97124

June 16, 2005

## 1. Removal of the drive carrier stop pin

The drive carrier stop pin in the drive bay of the SR1450 may be safely removed to allow the full insertion of the Hard-Drive-to-Floppy Conversion Kit as follows:

- Remove the Server Chassis SR1450 cover and front outer bezel (if present).
- Remove any hard disk drive or carrier from the middle drive bay of the chassis.
- Viewing from the rear of the Server Chassis SR1450, locate the carrier stop pin in the rail assembly of the middle drive bay.
- Using needle-nose pliers, grasp the drive carrier stop pin and unscrew it from the drive bay as shown.

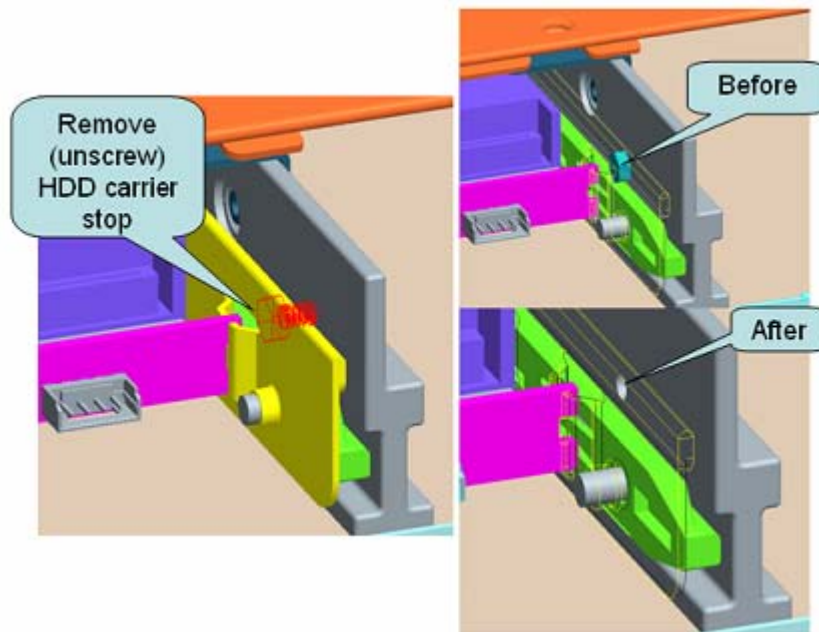

- Push the Hard-Drive-to-Floppy Conversion Kit into the chassis until it is completely installed in the Server Chassis SR1450 (clicks into place).
- Complete the installation according to the instructions contained in the conversion kit.

# intel® Technical Advisory

TA-799-1

5200 NE Elam Young Parkway  
Hillsboro, OR 97124

June 16, 2005

## 2. Flexing the cage of the conversion kit during installation.

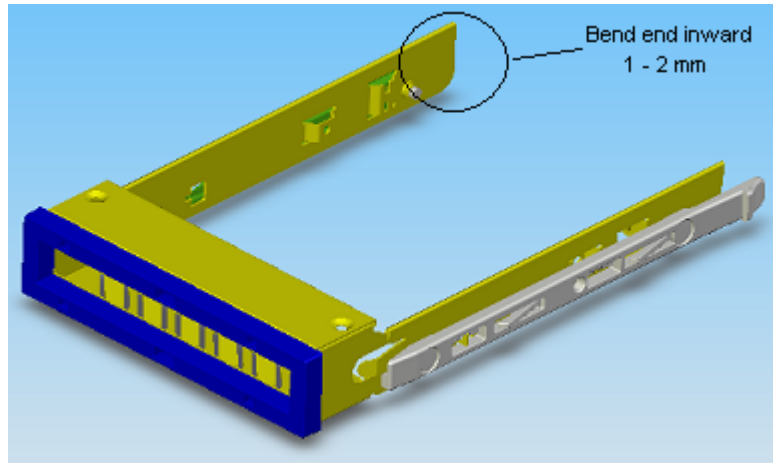

The conversion kit may be flexed during installation to allow its insertion in the chassis as follows:

- Remove the Server Chassis SR1450 front outer bezel (if present).
- Insert the cage of the Hard-Drive-to-Floppy Conversion Kit into the middle drive bay and push until it meets the stop pin.
- While pushing the Hard-Drive-to-Floppy Conversion Kit into the chassis, gently bend the left metal rail of the cage approximately 1 to 2 millimeters inward, as shown.

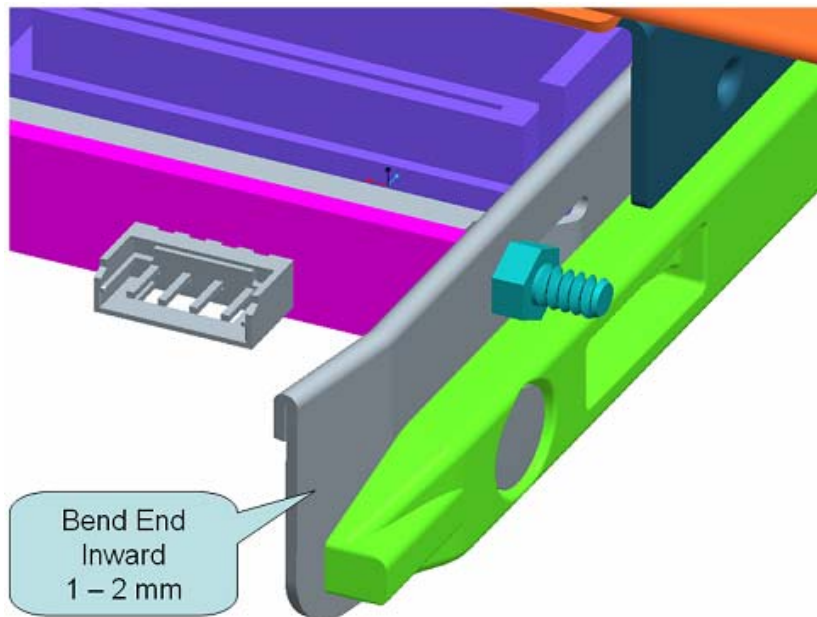

# intel<sup>®</sup> Technical Advisory

TA-799-1

5200 NE Elam Young Parkway  
Hillsboro, OR 97124

June 16, 2005

- Continue pushing the Hard-Drive-to-Floppy Conversion Kit into the chassis until the kit is completely installed (clicks into place) in the Server Chassis SR1450.
- Complete the installation according to the instructions contained in the conversion kit.

Please contact your Intel Sales Representative if you require more specific information about this issue.

Enterprise Platforms & Services Division  
Intel Corporation