

# Intel® Compute Card

User Guide

---

*August 2018*



You may not use or facilitate the use of this document in connection with any infringement or other legal analysis concerning Intel products described herein. You agree to grant Intel a non-exclusive, royalty-free license to any patent claim thereafter drafted which includes subject matter disclosed herein.

No license (express or implied, by estoppel or otherwise) to any intellectual property rights is granted by this document.

All information provided here is subject to change without notice. Contact your Intel representative to obtain the latest Intel product specifications and roadmaps.

The products described may contain design defects or errors known as errata which may cause the product to deviate from published specifications. Current characterized errata are available on request.

Copies of documents which have an order number and are referenced in this document may be obtained by calling 1-800-548-4725 or by visiting: <http://www.intel.com/design/literature.htm>.

Intel technologies' features and benefits depend on system configuration and may require enabled hardware, software or service activation. Performance varies depending on system configuration. No computer system can be absolutely secure.

Intel and the Intel logo are trademarks of Intel Corporation or its subsidiaries in the U.S. and/or other countries.

\*Other names and brands may be claimed as the property of others.

Copyright © 2018, Intel Corporation. All rights reserved.



## Contents

---

<b>1.0</b>	<b>Introduction .....</b>	<b>5</b>
1.1	Before You Begin .....	5
1.2	Observe Safety and Regulatory Requirements.....	5
<b>2.0</b>	<b>Product Description .....</b>	<b>6</b>
2.1	Intel® Compute Card Dock DK132EPJ.....	6
2.2	Intel® Compute Cards .....	7
<b>3.0</b>	<b>Connect a Keyboard and Mouse.....</b>	<b>8</b>
<b>4.0</b>	<b>Connect to a Network .....</b>	<b>9</b>
<b>5.0</b>	<b>Connect to a Display .....</b>	<b>10</b>
<b>6.0</b>	<b>Connect Power .....</b>	<b>11</b>
<b>7.0</b>	<b>Insert and Eject Intel Compute Card.....</b>	<b>12</b>
7.1	Insert a Card .....	12
7.2	Eject a Card.....	13
<b>8.0</b>	<b>Use the VESA Bracket (Optional).....</b>	<b>14</b>
<b>9.0</b>	<b>Security Considerations.....</b>	<b>16</b>
9.1	Software Security.....	16
9.2	Hardware Security .....	17
<b>10.0</b>	<b>Install an Operating System.....</b>	<b>18</b>
<b>11.0</b>	<b>Install the Latest Device Drivers and Software .....</b>	<b>19</b>



## Revision History

---

Date	Revision	Description
August 2018	5.0	Added Security Considerations section.
July 2018	4.0	Updated Driver and BIOS Updates section with CD1C32GK.
November 2017	3.0	Updated Driver and BIOS Updates section with CDIV128MK.
October 2017	2.0	Updated Driver and BIOS Updates section with DK132EPJ.
August 2017	1.0	Initial release.

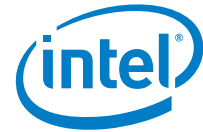

## 1.0 Introduction

---

This user guide includes setup and usage information for Intel® Compute Cards when used with the Intel® Compute Card Dock DK132EPJ.

### 1.1 Before You Begin



#### CAUTIONS

*The steps in this guide assume you're familiar with computer terminology and with the safety practices and regulatory compliance required for using and modifying computer equipment.*

*Disconnect the computer from its power source and from any network before performing any of the steps described in this guide.*

*Failure to disconnect power, telecommunications links, or networks before you open the computer or perform any procedures can result in personal injury or equipment damage. Some circuitry on the board can continue to operate even though the front panel power button is off.*

Follow these guidelines before you begin:

- Always follow the steps in each procedure in the correct order.
- Create a log to record information about your computer, such as model, serial numbers, installed options, and configuration information.
- Electrostatic discharge (ESD) can damage components. Perform the procedures described in this chapter only at an ESD workstation using an antistatic wrist strap and a conductive foam pad. If such a station isn't available, you can provide some ESD protection by wearing an antistatic wrist strap and attaching it to a metal part of the computer chassis.

### 1.2 Observe Safety and Regulatory Requirements

If you don't follow these instructions, you increase your safety risk and the possibility of noncompliance with regional laws and regulations.

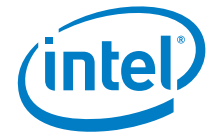

## 2.0 Product Description

---

### 2.1 Intel® Compute Card Dock DK132EPJ

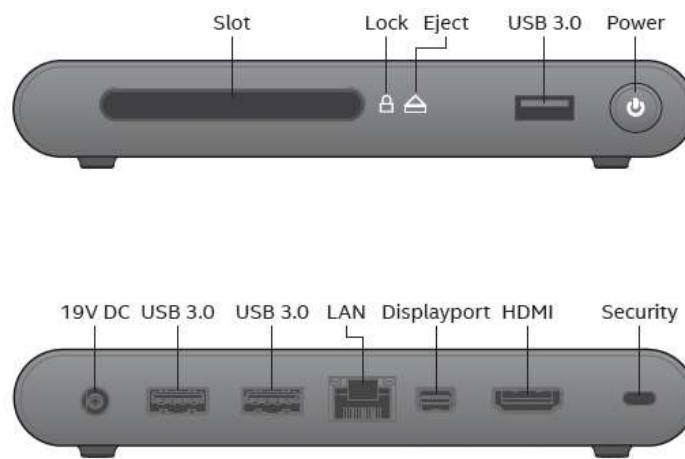

Symbol	Description
Slot	Slot for Intel Compute Card
Lock	Lock Indicator
Eject	Eject Button / Indicator
USB 3.0	One on front and two on back
Power	Power Button / Indicator
19V DC	Power input jack
LAN	Gigabit Ethernet port
Displayport	MiniDisplayPort connector
HDMI	HDMI (standard size) connector
Security	Security cable lock connector

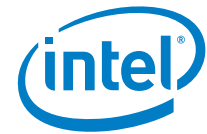

## 2.2 Intel® Compute Cards

### Top-front view

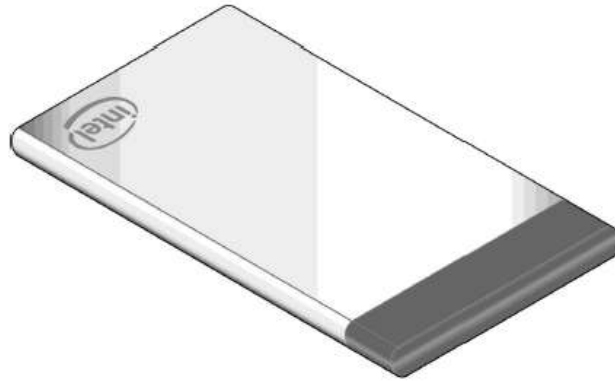

The two wireless antennas are located inside the black plastic end of the card.

### Bottom-back view

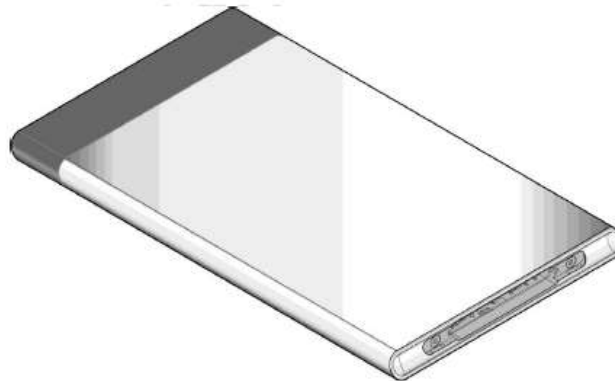



## 3.0 *Connect a Keyboard and Mouse*

---

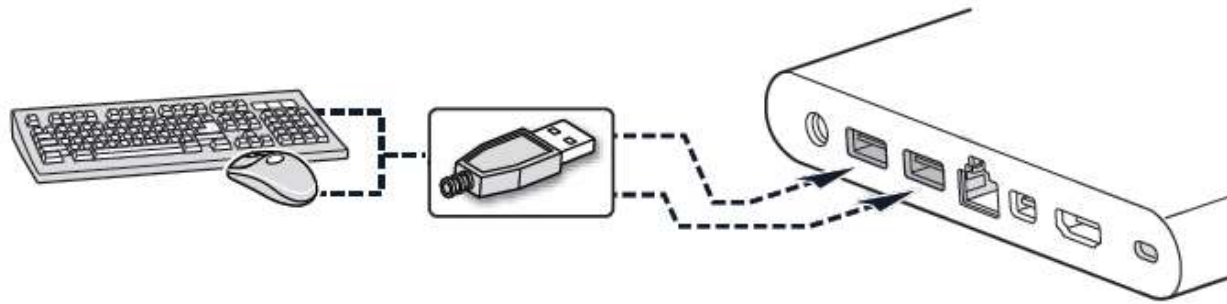

Intel Compute Card supports any of the following:

- USB wired keyboard and mouse, connected to the ports on the dock
- USB wireless keyboard and mouse, using a USB dongle connected to a port on the dock.
- Bluetooth\* keyboard and mouse. (Follow the instructions that came with the keyboard and mouse to pair them to the Intel Compute Card's onboard Bluetooth device. You may need to temporarily connect a wired mouse/keyboard to the dock in order to pair Bluetooth devices.

**Note:** Keyboard and mouse aren't included.

Find tested keyboards and mice on the [Intel® Product Compatibility Tool](#).



## 4.0 *Connect to a Network*

---

There are two options for connecting to a network.

1. The Dock includes an RJ45 LAN connector for a wired Gigabit Ethernet network connection.

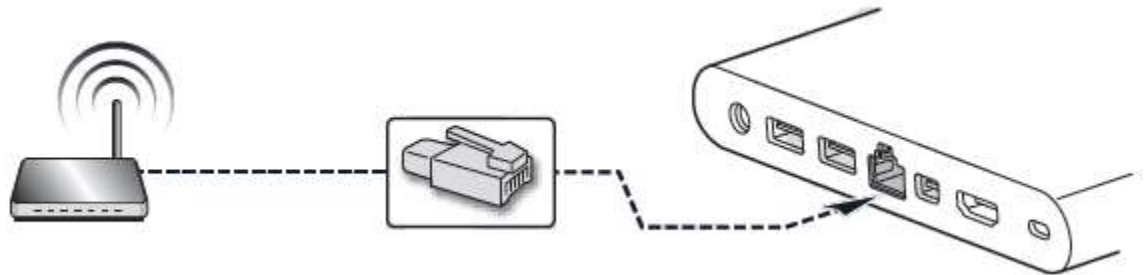

2. The Card includes wireless capability that you can use after installing an operating system and wireless device drivers.

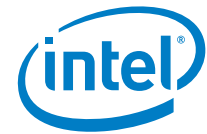

## 5.0 *Connect to a Display*

---

The Intel Compute Card Dock connects to the display using either the DisplayPort or HDMI connector on the back panel.

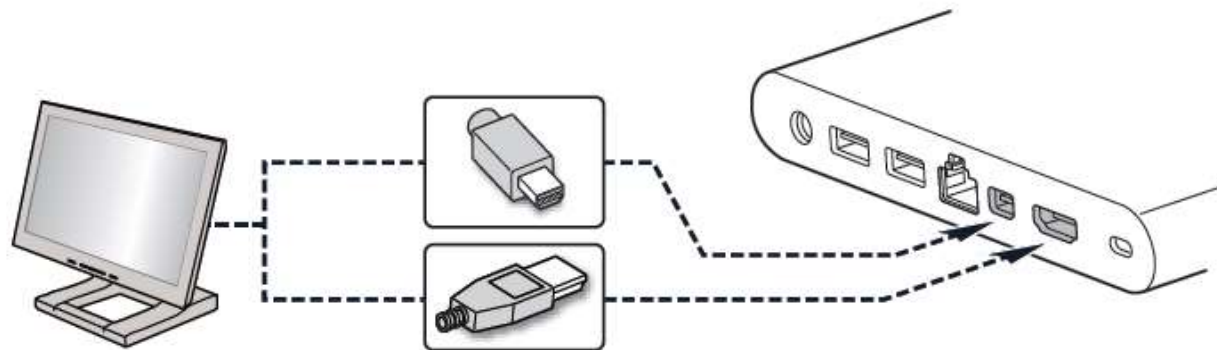



Find tested monitors and televisions on the [Intel® Product Compatibility Tool](#).

## 6.0 Connect Power

Country-specific power plug attachments are included in the Intel Compute Card Dock box.

1. Choose the attachment for your region.

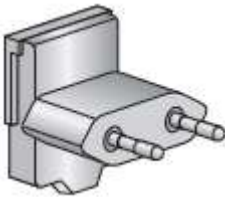
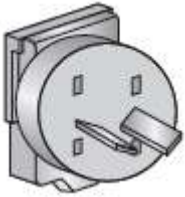
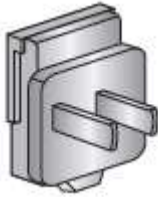
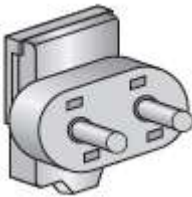
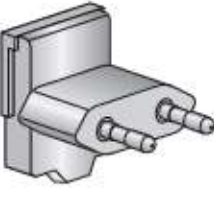
			
US – United States	UK – United Kingdom	EU – European Union	AU - Australia
			
CN - China	IN - India	KR – South Korea	

2. Slide the attachment (B) onto the power plug, locking it into place (A).

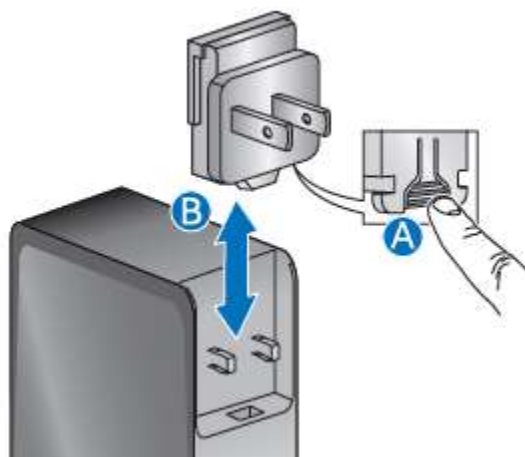

3. Connect to AC power.

## 7.0 *Insert and Eject Intel Compute Card*

---

### 7.1 **Insert a Card**

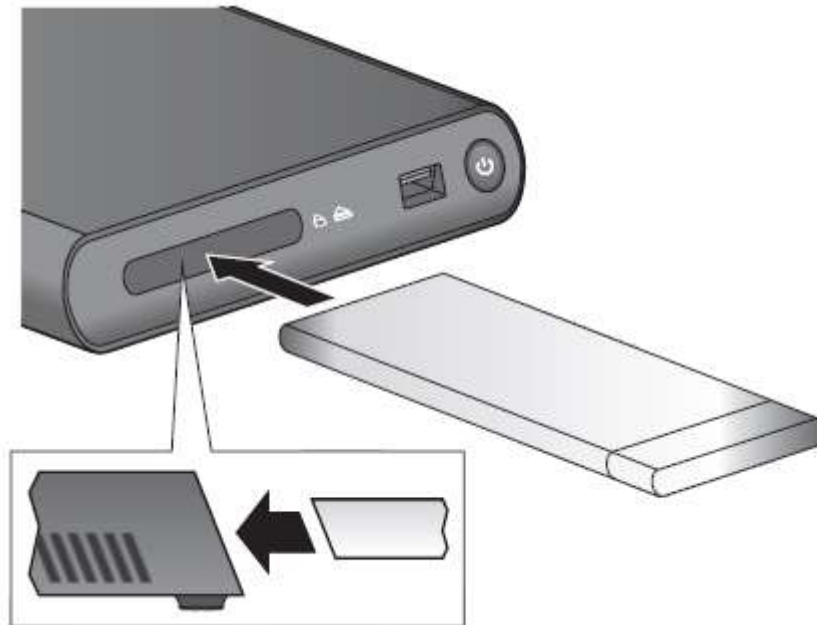

## 7.2 Eject a Card

When ejecting a card, the fan in the Dock will first cool the card to a safe temperature level before ejecting it. There are two ways to eject a card from the dock.

### 1. Hardware eject button on the dock front panel

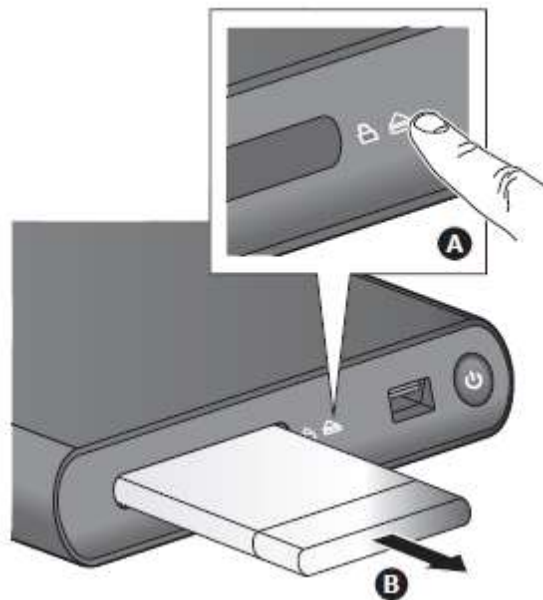

### 2. Software eject using the Intel® Compute Card Lock and Eject Tool

- a. Download and install the **Intel® Compute Card Lock and Eject Tool**.
- b. Right-click the tray icon and select **Eject**.
- c. Choose one of the following options:
  - Hibernate and Eject
  - Shutdown and Eject

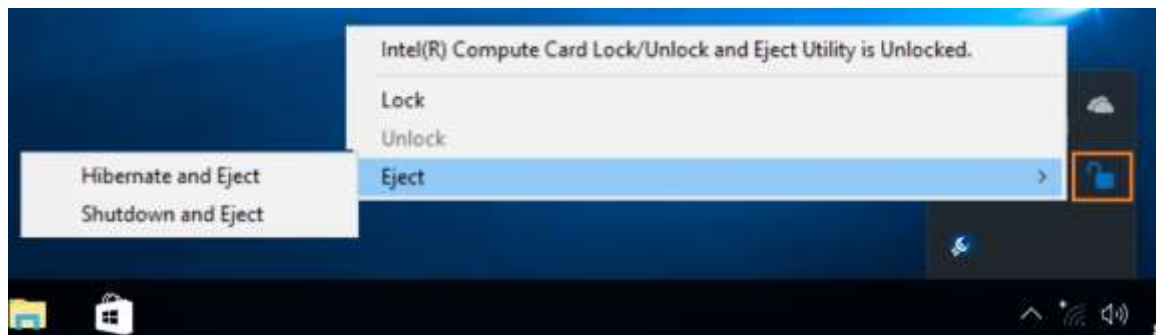

## 8.0 Use the VESA Bracket (Optional)

Follow these instructions to attach and use the VESA mount bracket with the Dock.

1. Attach the VESA bracket to the back of the monitor or display, using the four small black screws.

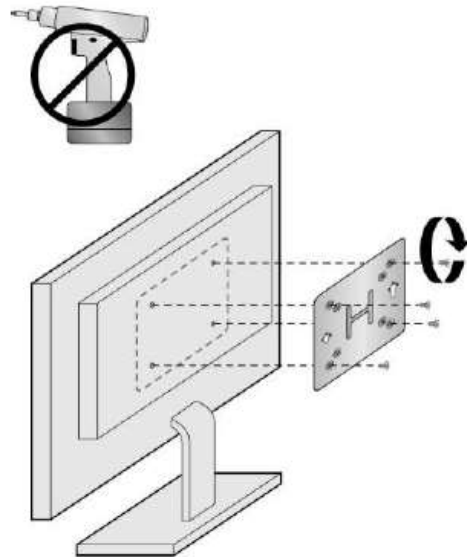

2. Attach the two large black screws that were included in the box to the bottom of the Dock.

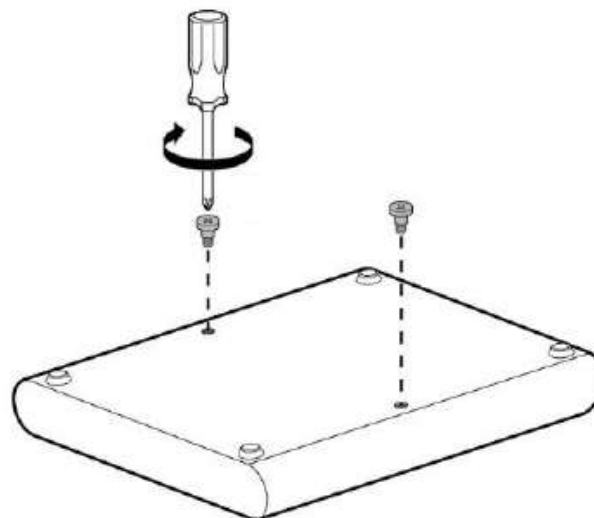

3. Slide the Dock onto the VESA mount bracket.

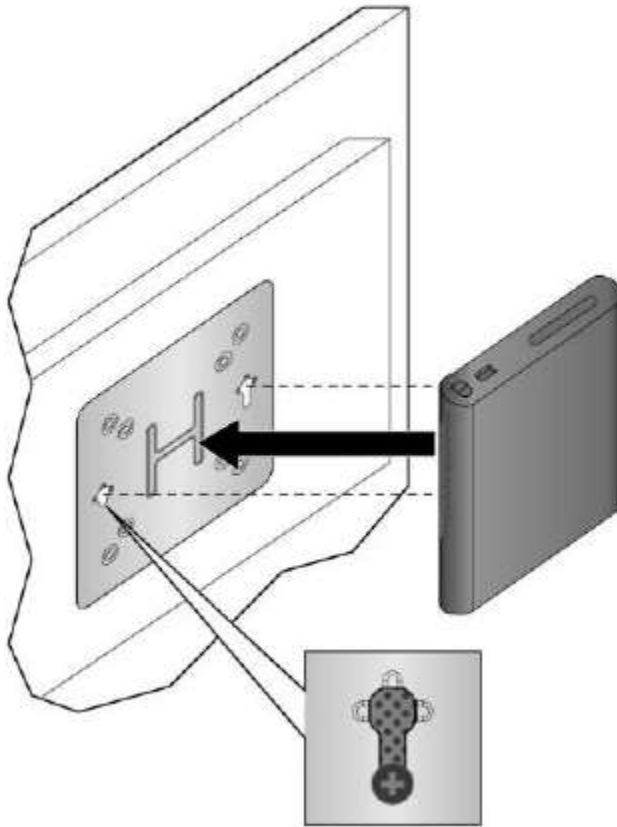

## 9.0 Security Considerations

---

### 9.1 Software Security

The Intel® Compute Card Dock [Lock and Eject Tool](#) is a Windows\* tray application that allows you to lock/unlock and eject an Intel Compute Card from the Intel® Compute Card Dock DK132EPJ.

Right-click the tray icon to:

- View the lock status of the Card
- Lock the Card into the Dock
- Unlock a previously locked Card from the Dock
- Eject the Card from a Dock during either hibernation or shut down.

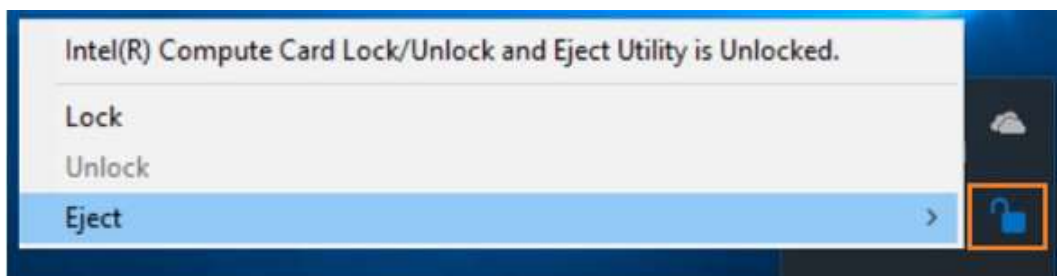

The tray icon indicates the lock state of the Card.

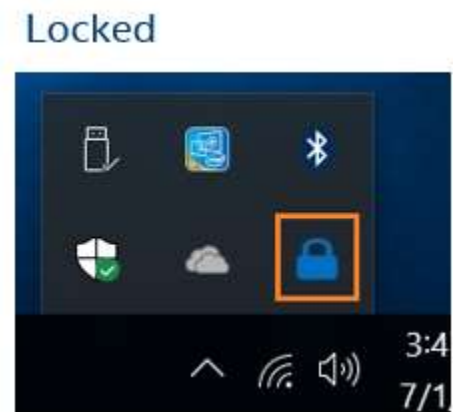



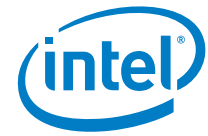

## 9.2 Hardware Security

You can use a security cable with the Kensington lock on the Intel Compute Card Dock.

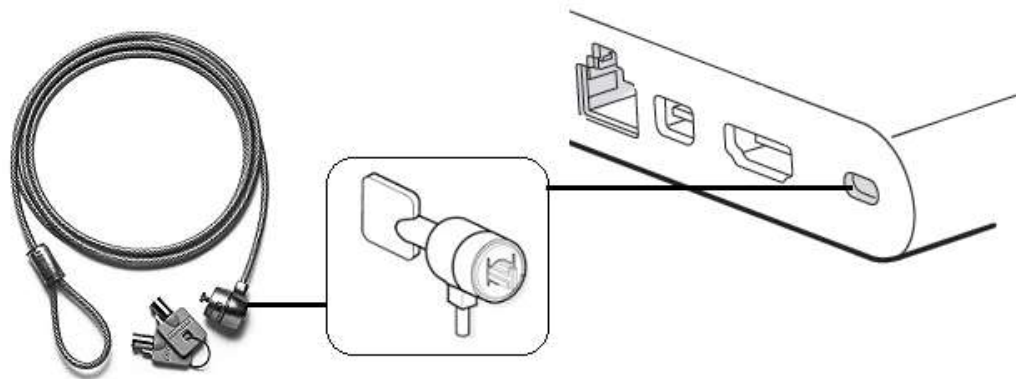

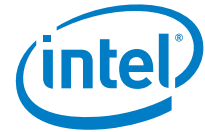

## 10.0 *Install an Operating System*

---

See [Supported Operating Systems](#) for a list of Intel-validated Windows\* operating systems.

The [Intel Product Compatibility Tool](#) lists versions of Linux\* that have been reported as compatible by Intel NUC owners. If you need assistance with Linux on your Intel NUC, check the distribution's website and forums for peer assistance.

Refer to [Operating System Installation](#) for system requirements and installation steps.

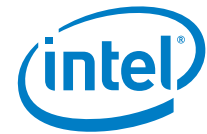

## 11.0 Install the Latest Device Drivers and Software

Here are the options for keeping device drivers current:

- Allow the [Intel® Driver & Support Assistant \(Intel® DSA\)](#) to detect out-of-date drivers
- Manually download drivers, BIOS, and software from Download Center:
  - [CD1IV128MK](#)
  - [CD1M3128MK](#)
  - [CD1C32GK](#)
  - [CD1C64GK](#)
  - [CD1P64GK](#)

The table shows the available downloads.

Download	CD1IV128MK	CD1M3128MK	CD1C32GK, CD1C64GK, CD1P64GK
Intel® Chipset Device Software	x	x	x
Intel® HD Graphics	x	x	x
Intel® Management Engine (Consumer)		x	
Intel® Management Engine (Corporate)	x		
Intel® Trusted Execution Engine			x
Intel® Wireless Technology	x	x	x
Intel® Bluetooth Technology	x	x	x
Intel® Gigabit Network Connection	x	x	x
Intel® Serial IO Host Controller	x	x	x
HID Event Filter			x
Lock and Eject Tool	x	x	x
System BIOS	x	x	x